



# ALBERT HALL

BRUSSELS

PARKING,  
ACCESS  
& SHUTTLES



# PARKING

Parking VIP



Parking Delhaize

Place Saint-Antoine  
Etterbeek

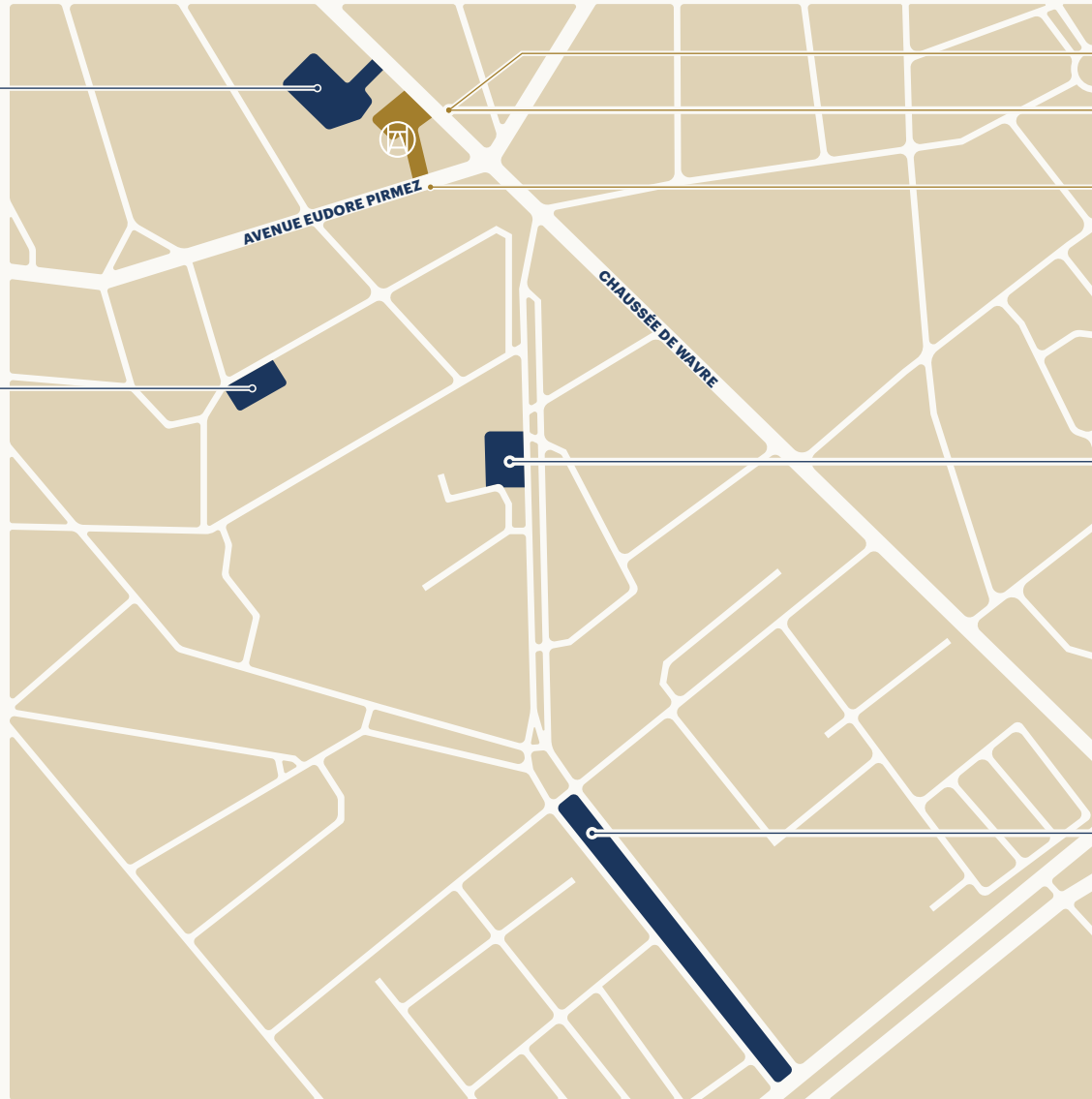

Bus 34

Bus 36

Tram 81



Parking Town Hall

31 Avenue des Casernes  
Etterbeek



Parking

Avenue du Deuxième  
Régiment de Lanciers

| <b>Number of available parking places *</b> |                                     | DAY        | EVENING         | DISTANCES               |
|---|-------------------------------------|------------|-----------------|-------------------------|
| <b>Covered car parks</b>                    | Total Covered                       | 130        | 165             |                         |
|   | Delhaize                            | 50         | 70 <sup>1</sup> | Walking distance (300m) |
|   | Town Hall                           | 80         | 95 <sup>2</sup> | Walking distance (300m) |
| <b>On street car parks</b>                  | Avenue 2 <sup>e</sup> Reg. Lanciers | 200        | 200             | 500-750m (Shuttles)     |
| <b>Total</b>                                |                                     | <b>330</b> | <b>365</b>      |                         |

### Tariffs parking spaces (VAT Excluded)

|  |   |
|--|---|
| <b>Delhaize</b>                        | <p><b>Full day 20€<sup>3</sup> / After 19h 10€<sup>3</sup></b><br/>           Code given to your guests in exchange for their entry ticket.<br/>           Covered car park, not secured but can be secured by an on-site security guard.</p> |
| <b>Townhall</b>                        | <p><b>1€/hour reserved/place reserved</b><br/>           Free exit ticket given in exchange for their entry ticket.<br/>           Covered car park, secure 24/7.</p>   |
| <b>Av. 2<sup>e</sup> Reg. Lanciers</b> | <p><b>Flat fee 500€ / 2€/hour reserved/place reserved</b><br/>           Car park is on the road, not secured and 500 to 750m from our site.<br/>           Need for shuttles and on-site surveillance. No ticket, no code.</p>               |

\* Request for rental must be managed via Albert Hall Brussels one month in advance / <sup>1</sup> After 19h / <sup>2</sup> After 17h / <sup>3</sup> Per place reserved

# PARKING VIP

**Trucks parking area**  
± 4 trucks of 20m<sup>3</sup>

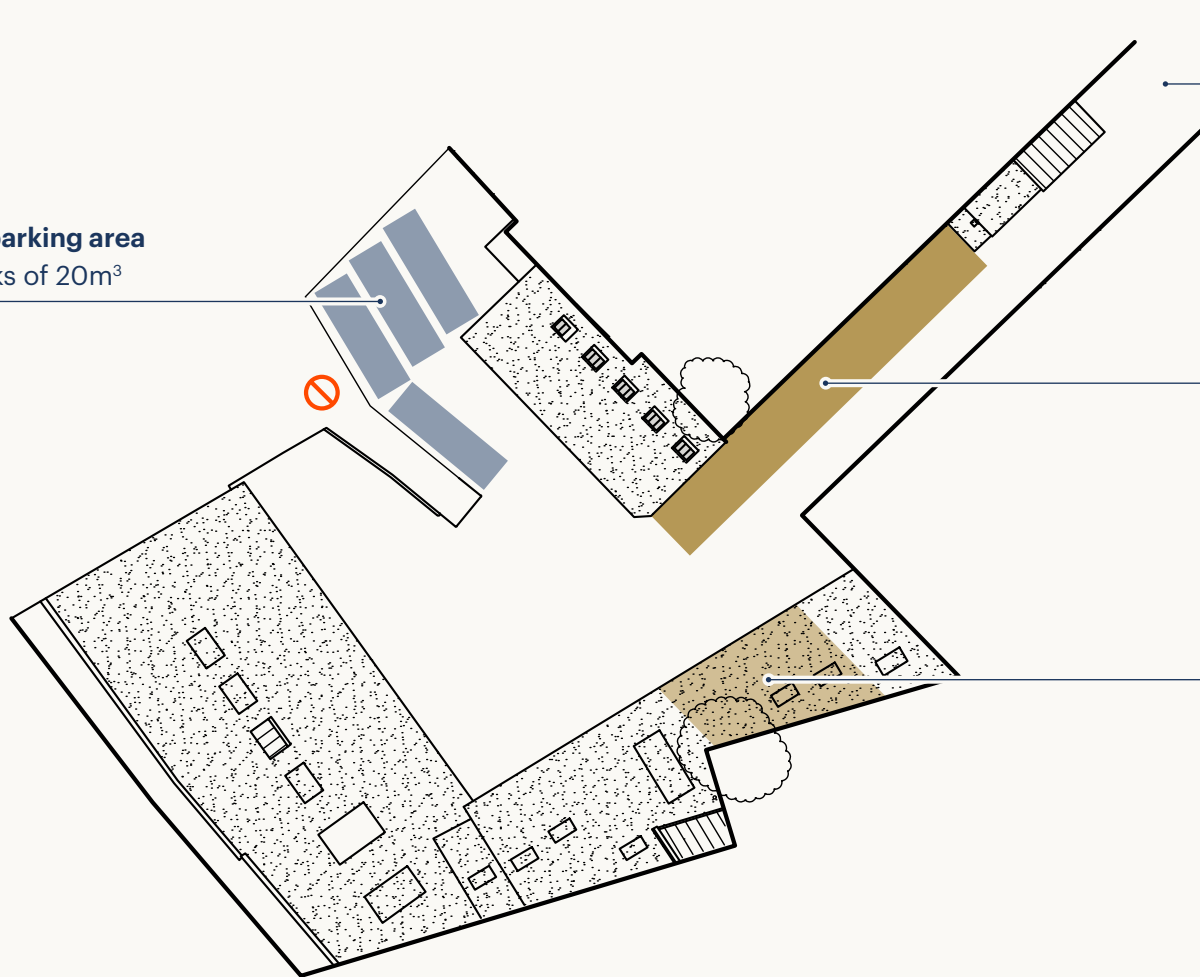

**637b Chaussée de Wavre**  
50m away from our entrance

**Vip parking area**  
5 cars

**Bike boxes**  
15 places

# DELIVERY ZONE



## DELIVERY ZONE

21m just in front of our building

To be booked if necessary  
with the municipality  
by the Albert Hall Brussels

# PUBLIC TRANSPORT

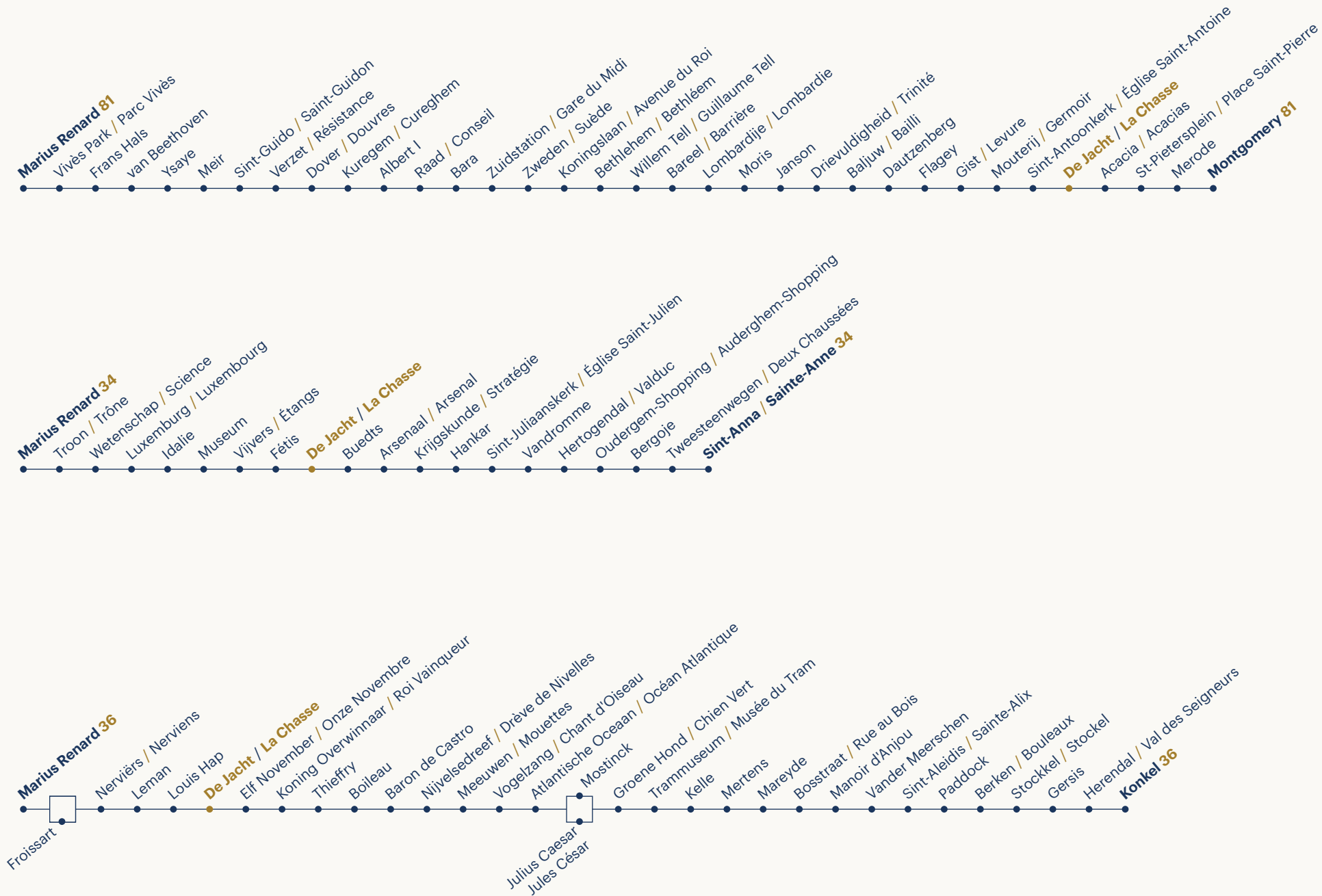

# SHUTTLE



## SHUTTLE SERVICES

### Modern Car

We recommend you their services

+32 2 420 10 00  
[info@moderncar.com](mailto:info@moderncar.com)



# ALBERT HALL BRUSSELS

---

Chaussée de Wavre, 649-651  
B-1040 Brussels

T +32 470 66 44 89 / [info@albert-hall.com](mailto:info@albert-hall.com)

[www.albert-hall.com](http://www.albert-hall.com)